



INTELLIGENT MANUAL PULL STATION

GENERAL

The Fike Intelligent Manual Pull Station, P/N 20-1063, is a state-of-the-art, dual-action (i.e., requires two motions to activate the station) pull station that includes an addressable interface (mounted inside) for Fike's intelligent CyberCat and Cheetah Xi fire alarm control panels. Because the 20-1063 is addressable, the control panel can display the exact location of the activated manual pull station. This leads fire service personnel quickly to the location of the alarm.

FEATURES

- Aesthetically pleasing, highly visible, dual-action design.
- Meets ADA 5 lb. maximum pull force.
- Easily operated (dual-action).
- Attractive shape and textured finish.
- Mounts, semi-flush, to a standard single-gang (2.125" [5.398 cm] minimum depth), double-gang, or 4.0" (10.16 cm) square electrical box.
- When the handle latches in down position, the word "ACTIVATED" appears at the top of the handle in bright yellow to clearly indicate the station has been operated.
- Key/lock reset; needs only a 1/4-turn to lock/unlock.
- Includes Braille text on station handle.
- Captive screw terminals wire-ready for easy connection to SLC loop (accepts up to 12 AWG/3.1 mm² wire).
- Meets UL 38, Standard for Manually Actuated Signaling Boxes.
- Maintenance personnel can open station (for inspection and testing) without causing an alarm condition.
- Built-in multi color LED, which is visible through the handle of the station, flashes red in normal operation and latches on steady red when in alarm.

ENGINEERING SPECIFICATIONS

Manual Fire Alarm Stations shall be non-coded, with a keyoperated reset lock in order that they may be tested, and so designed that after actual Emergency Operation, they cannot be restored to normal except by use of a key. An operated station shall automatically condition itself so as to be visually detected as activated. Manual stations shall be constructed of red-colored LEXAN® (or polycarbonate equivalent) with clearly visible operating instructions provided on the cover. The word FIRE shall appear on the front of the stations in white letters, 1.00 inches (2.54 cm) or larger. Stations shall be suitable for surface mounting or semi-flush mounting on a standard single-gang, double-gang, or 4.0" (10.16 cm) square electrical box, and shall be installed within the limits defined by the Americans with Disabilities Act (ADA) or per national/local requirements.

Manual Stations shall be Underwriters Laboratories listed. Manual stations shall connect with two wires to one of the control panel SLC loops. The manual station shall, on command from the control panel, send data to the panel representing the state of the manual switch. Manual stations shall provide address setting by use of IR Tool.



Intelligent Manual Pull Station

APPROVALS

- UL S2203
- FM 3020297
- MEA pending
- CSFM pending

ELECTRICAL SPECIFICATIONS

Normal operating voltage: 24 VDC.

Maximum SLC loop voltage: 28.0 VDC.

Maximum SLC loop current: 230 μ A.

INSTALLATION

The 20-1063 can be semi-flush mounted into a single-gang, double-gang, or standard 4.0" (10.16 cm) square electrical outlet box, or surface mounted.

CONSTRUCTION

Shell, door, and handle are molded of durable LEXAN® (or polycarbonate equivalent) with a textured finish.

OPERATION

Pushing in, then pulling down on the handle causes it to latch in the down/activated position. Once latched, the word "ACTIVATED" (in bright yellow) appears at the top of the handle, while a portion of the handle protrudes from the bottom of the station. To reset the station, simply unlock the station with the key and pull the door open. This action resets the handle; closing the door automatically resets the switch.

Manual stations connect with two wires to one of the control panel SLC loops. Each manual station, on command from the control panel, sends data to the panel representing the state of the pull station switch. IR tool allows address setting (01-254).

PRODUCT LINE INFORMATION

20-1063 Dual-action addressable pull station.

Includes key lock/reset feature.

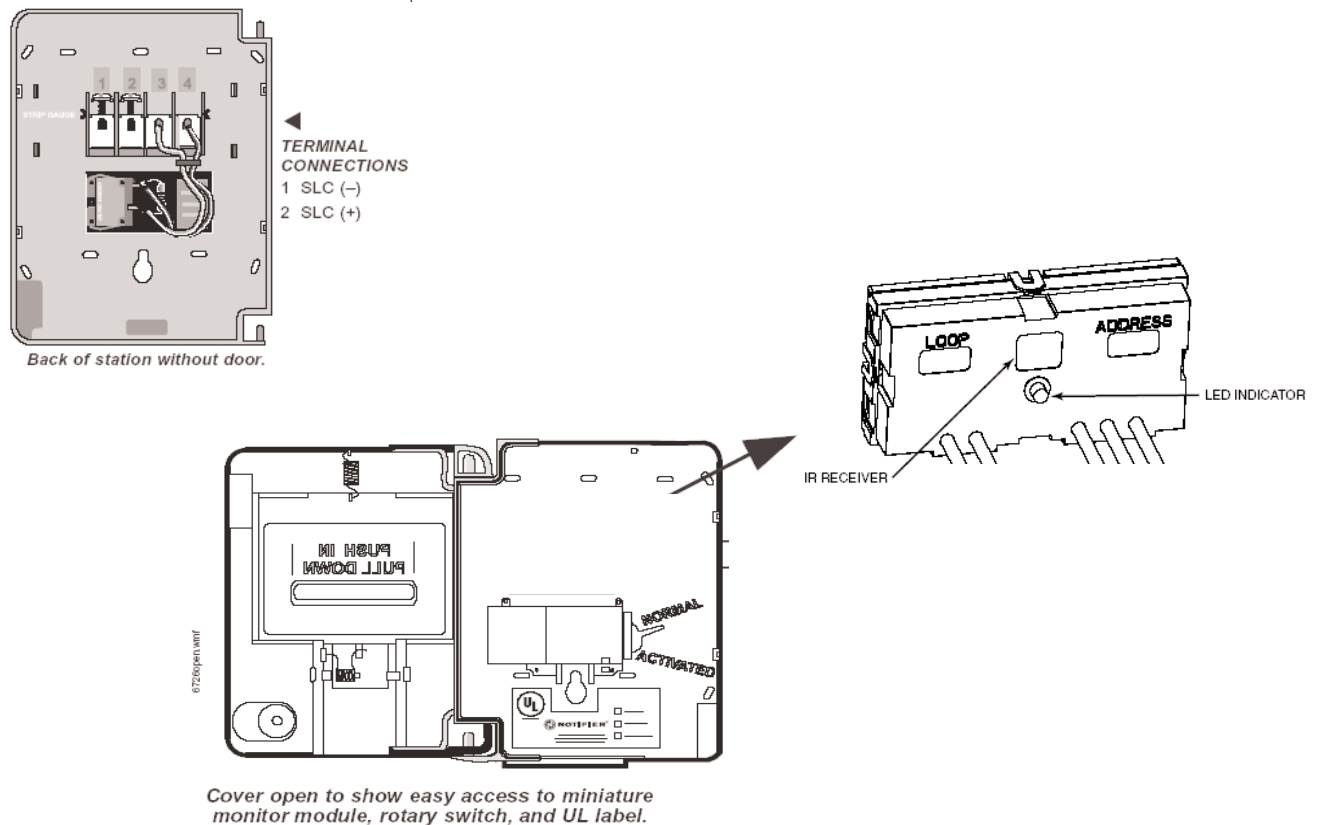

Copyright © Fike Corporation All Rights Reserved.

Form No. P.1.65.01-1 August, 2005 Specifications are subject to change without notice.